

Regione Piemonte Città Metropolitana di Torino
Comune di Venaus



PROGETTO DEFINITIVO/ESECUTIVO
FABBRICATO MICROCENTRALE ELETTRICA A SERVIZIO
DEL NUOVO EDIFICIO SCOLASTICO COMUNALE

Il Responsabile LL.PP. :

tecnico incaricato : arch. Marina Candia

Via C. Colombo n°4
10128 Torino
C.F. 01674590984
P.I. 0517170014

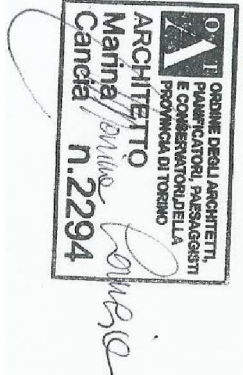

PIANTE, PROSPETTI e SEZIONI

TAVOLA
02

Scale varie

REVISIONI	Data	Distribuzione
01	Maggio 2018	

Dicembre 2017

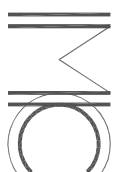

marina candia

architetto

via c. colombo 4
10128 Torino
Tel. +39 338 7474702
Fax +39 011 595313
email: canciama@virgilio.it

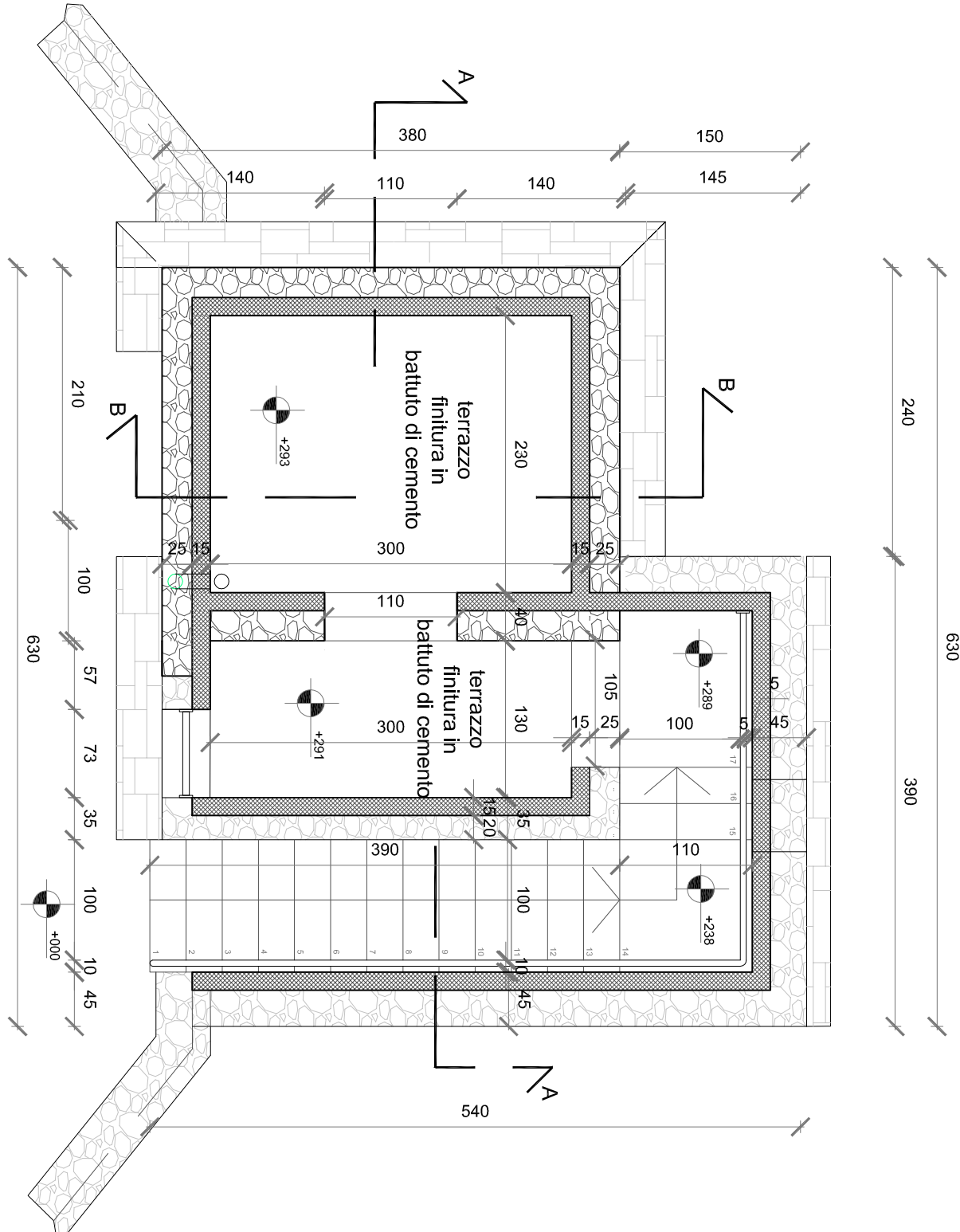

PIANTA PIANO PRIMO +2.93

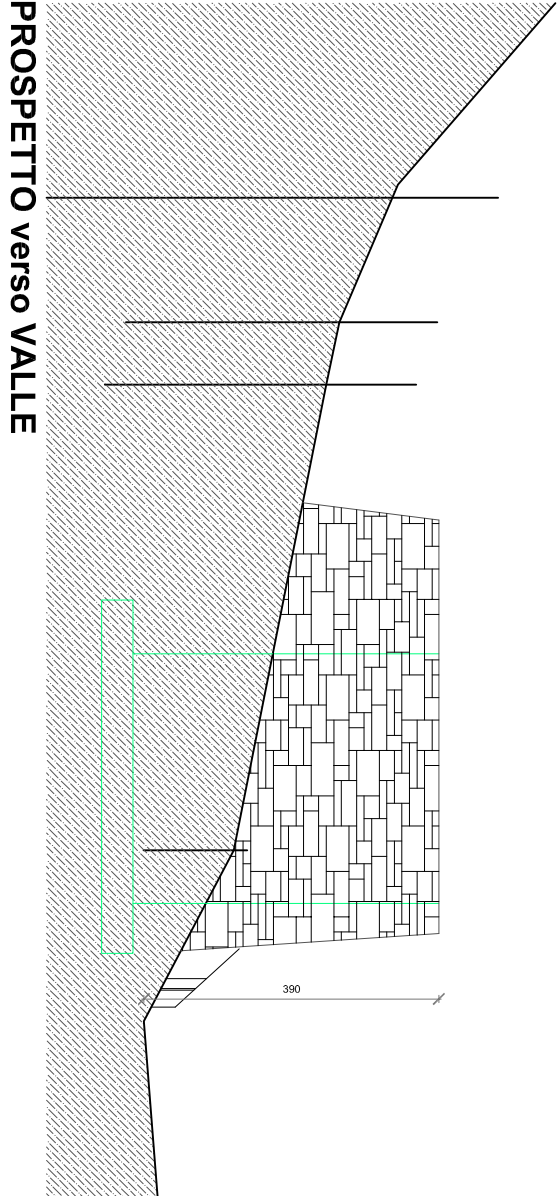

PROSPETTO verso VALLE

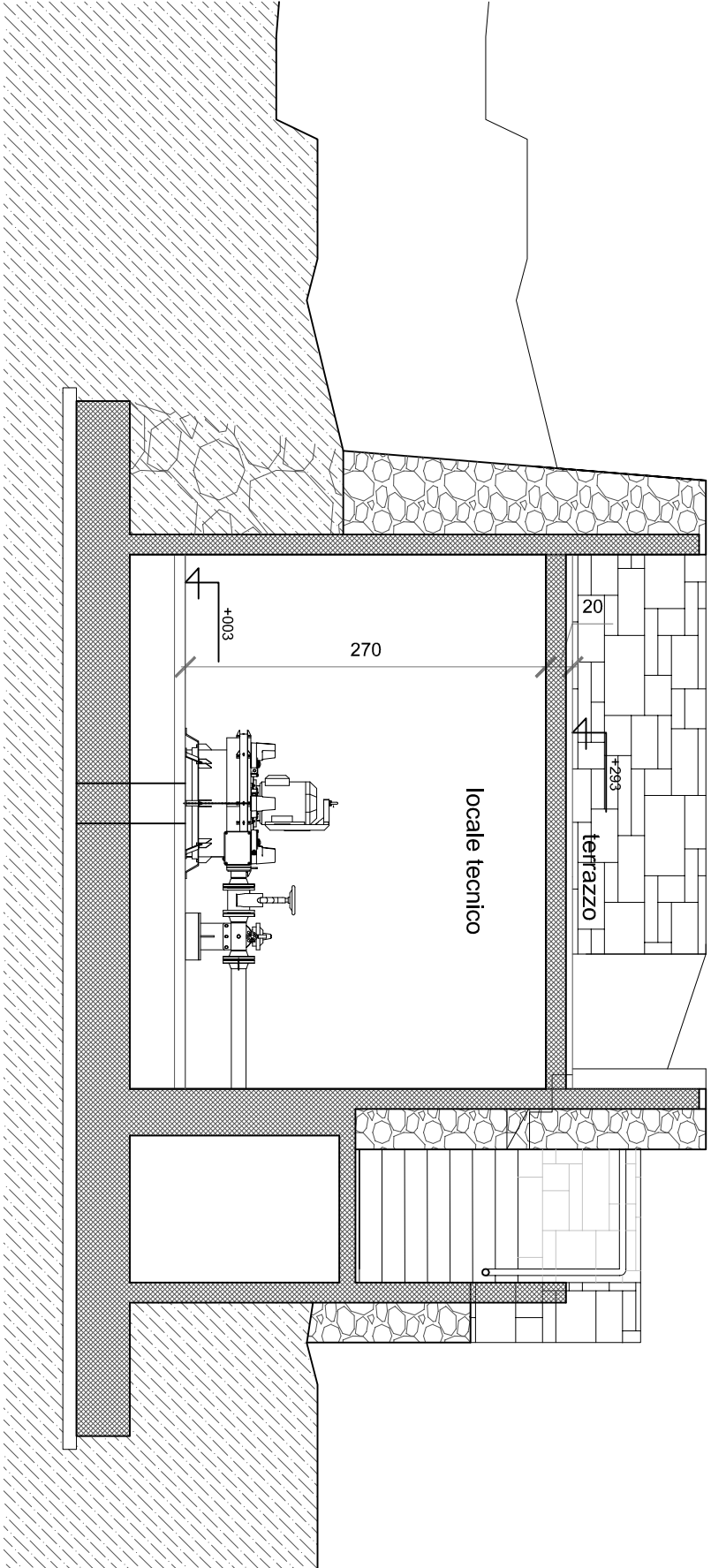

PROSPETTO STRADA

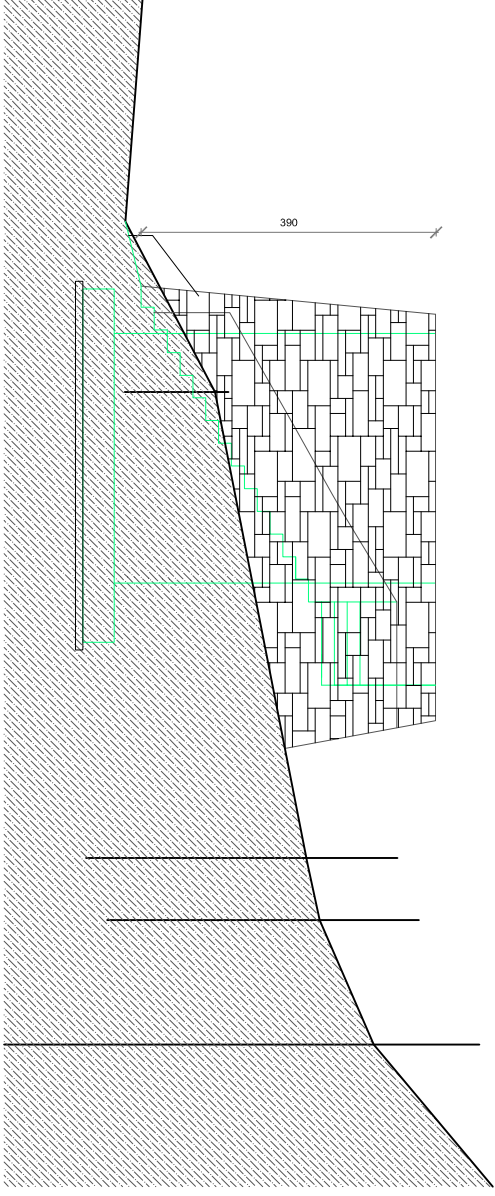

PROSPETTO verso MONTE

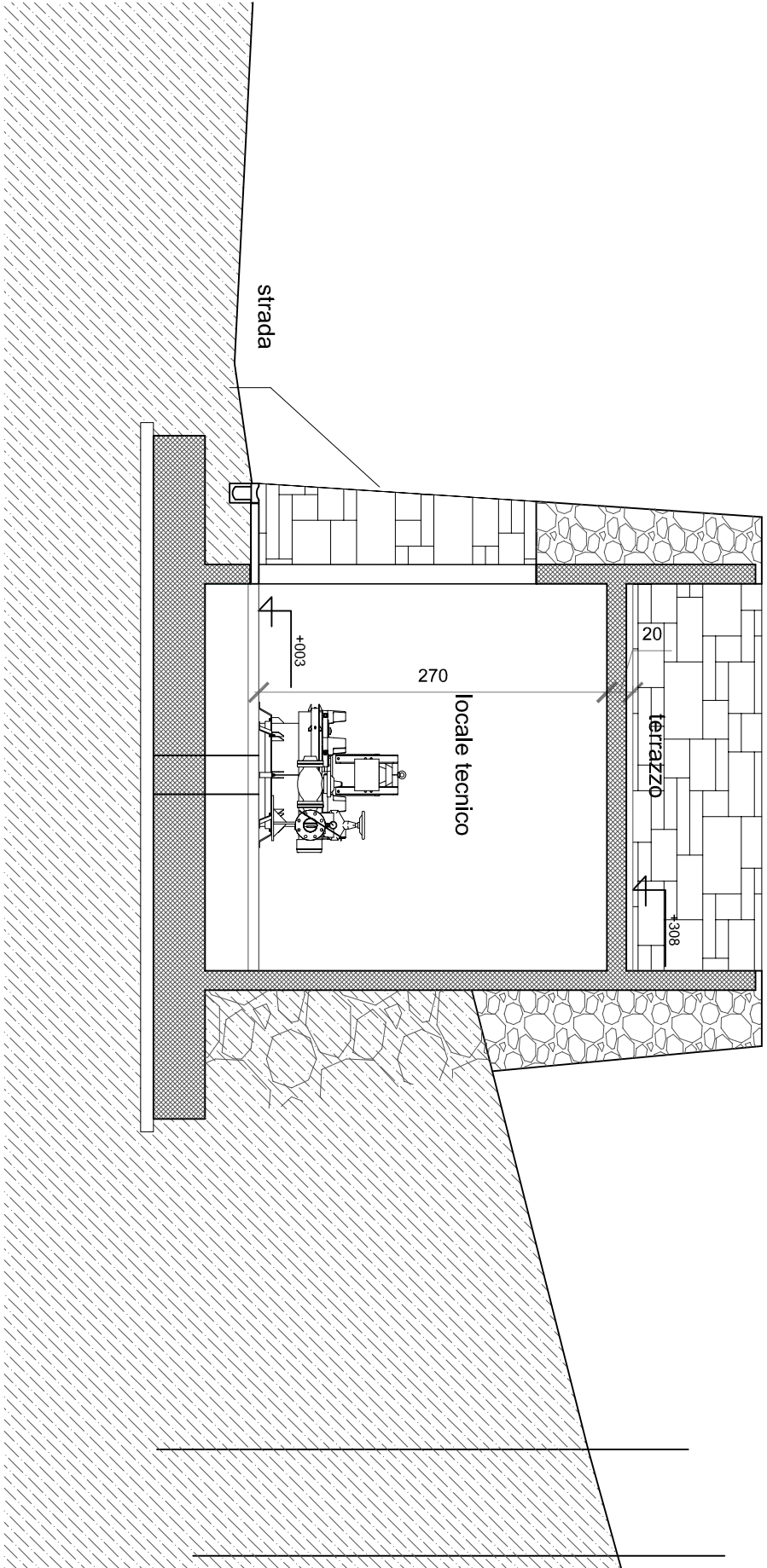

PROSPETTO POSTERIORE

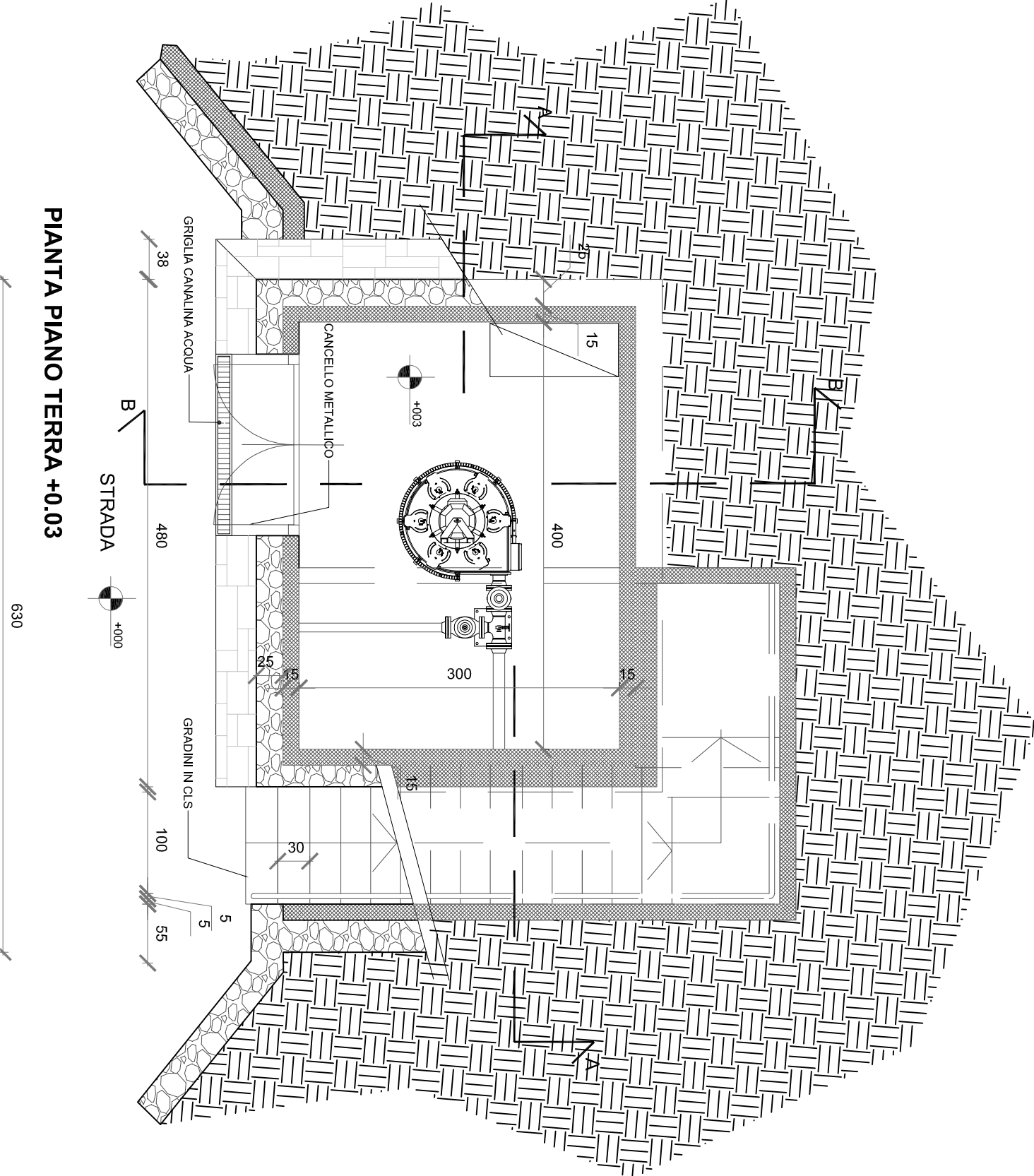

PIANTA PIANO TERRA +0.03